

# Lake Parks Information

## SUMMARY OF RULES AND REGULATIONS

For your safety and enjoyment of the parks please observe the following rules:

- No Glass Containers in designated areas or within 100 feet of the water.
- No firearms or fireworks are permitted, including BB guns, air rifles, bow and arrow and paintball guns.
- Campers must be at least 18 years of age or with a parent or guardian.
- All vehicles must be street legal to be operated in the park. No ATV's, Golf Carts or Go-Carts, etc.
- Obey speed limits, warning signs and traffic laws.
- No vehicle or camper washing.
- No wading pools larger than 6 feet in diameter and 12 inches deep, no sprinklers.
- Fires are allowed only in the areas that are designated. COLLECTING OR CUTTING WOOD IN THE PARKS IS PROHIBITED. Subject to City fines.
- Camping is allowed in designated areas only.
- No more than 1 wheeled camping unit per site and no more than 8 people per site.
- Vehicles must maintain all wheels off paved surface while parallel parking. Head-in parking off the pavement is not allowed.
- Quiet time is 10 pm. Loud, unnecessary noises and improper conduct are not permitted at any time.
- Check out time for campers is 12 pm.
- All pets must be leashed. Visitors with pets that present a threat or disturb other visitors will be asked to remove their pets from the park. **PETS ARE NOT ALLOWED ON THE SWIMMING BEACHES OR PLAYGROUNDS** at any time. Pets cannot be left unattended at any time.
- Reservations must be made for a minimum of two nights except holidays which require a 3 night minimum. Campsites will be assigned for walk-up and day-of-reservations. Cancellation more than 14 days from day of reservation - \$10 cancellation fee. Cancellation 14 to 1 day from reservation - forfeit of the amount of one night's stay. Cancellation day of - no refund.
- All reservation must be paid in-full at time of booking

Have a good time, but be considerate of your neighbor's rights and please help us keep the park clean! Campsites without a reservation will not be sold after 10 pm. Fees subject to change.

### Grand Prairie Parks, Arts & Recreation Lake Parks Office

5610 Lake Ridge Pkwy., Grand Prairie, Texas 75052  
GrandFunGP.com | LoydPark.com  
For Reservations, call (972) 237-4120  
Monday - Friday 8am-4:30pm

## SUMMARY OF FEES:

### Annual Pass

\$125 Primary Pass  
\$50 Secondary Pass

\*Family can purchase 2 maximum. May not be used on holidays and some special events.

### LYNN CREEK PARK:

#### Vehicle Fees

Grand Prairie Resident FREE w/valid drivers license (except holidays, special events and during Prairie Lights). Boat launch fee is an additional \$10. Other restrictions may apply.

**Non Resident** \$10 per vehicle/day (up to 6 people)

**Additional people** \$2 each

Children 5 and under Free

**Non Resident Seniors** \$2/ person  
A senior in a vehicle with adults (ages 6-64) will be charged \$10 for that vehicle

Holiday/Event Vehicle Fees may apply

**Boat launch fee** Incl. w/ vehicle fee

### LOYD PARK:

**Vehicle fee (regular)** \$10 per vehicle/day

Holiday/Event Vehicle Fees may apply

**Boat launch fee** Incl. w/ vehicle fee

**Seniors** \$2/ person

A senior in a vehicle with adults (ages 6-64) will be charged \$10 for that vehicle

#### Camping (does not include Vehicle fee)

Campsite, basic \$20 per night  
Campsite, lake view \$23 per night  
Campsite, lake front \$28 per night  
Campsite, full hookup \$25 per night  
Group campsites \$175 per night  
Group Picnic Pavilion \$75/day Mon.-Thurs.  
\$200/day Fri.-Sun.  
\$300/day Holidays & Holiday weekends

Check out time for campers - 12 pm

#### Cabins - (all cabin prices exclude tax)

1 bedroom \$150/night Mon.-Thurs.  
\$175/night Fri.-Sun.  
\$200/night Holidays & Holiday weekends  
2 bedroom \$200/night Mon.-Thurs.  
\$225/night Fri.-Sun.  
\$250/night Holidays & Holiday weekends

Check in - 2 pm; Check out - 11 am  
One vehicle fee included for duration of stay

**Loyd Lodge (18-rooms) - Call or visit website**

### BRITTON PARK:

Vehicle fee: \$5 per vehicle

**Holidays are defined as: Easter, Memorial Day, July 4th, and Labor Day.**

Grand Prairie PARKS, ARTS & RECREATION

# LAKE PARKS

JOE POOL LAKE



Enjoy your stay at Joe Pool Lake!



**NRPA**  
**Gold Medal Department**  
Grand Prairie Parks, Arts & Recreation

5610 Lake Ridge Pkwy. • Grand Prairie, TX 75052

GrandFunGP.com • LoydPark.com

For Reservations, call 972-237-4120

Grand Prairie  
TEXAS  
Dream Big ★ Play Hard

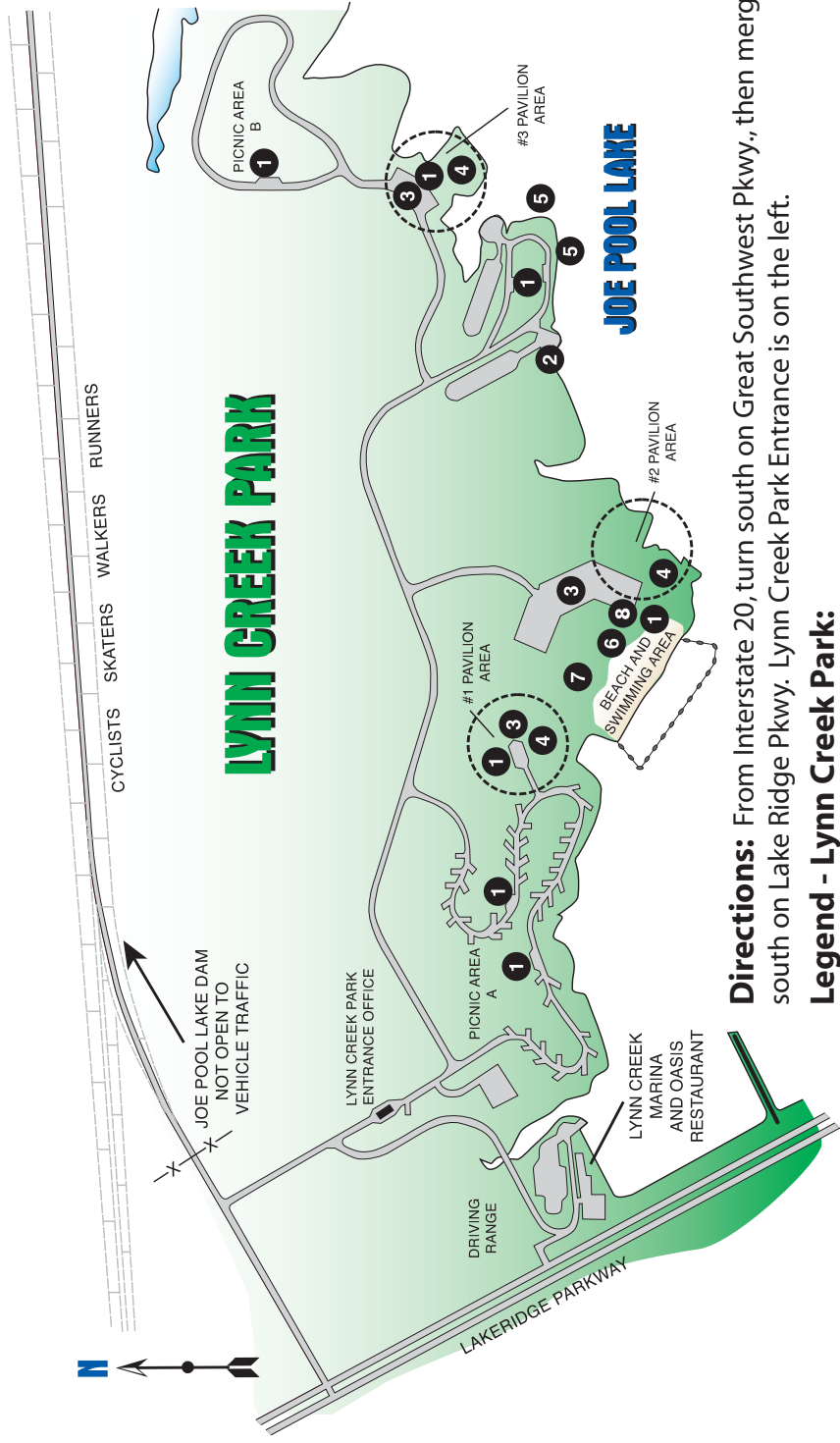

**Directions:** From Interstate 20, turn south on Great Southwest Pkwy., then merge south on Lake Ridge Pkwy. Lynn Creek Park Entrance is on the left.

**Legend - Lynn Creek Park:**

- 1. Restroom
- 2. Boat Ramp
- 3. Parking Lot
- 4. Group Picnic Area
- 5. Boat Dock
- 6. Beach Changing House
- 7. Playground
- 8. Concessions

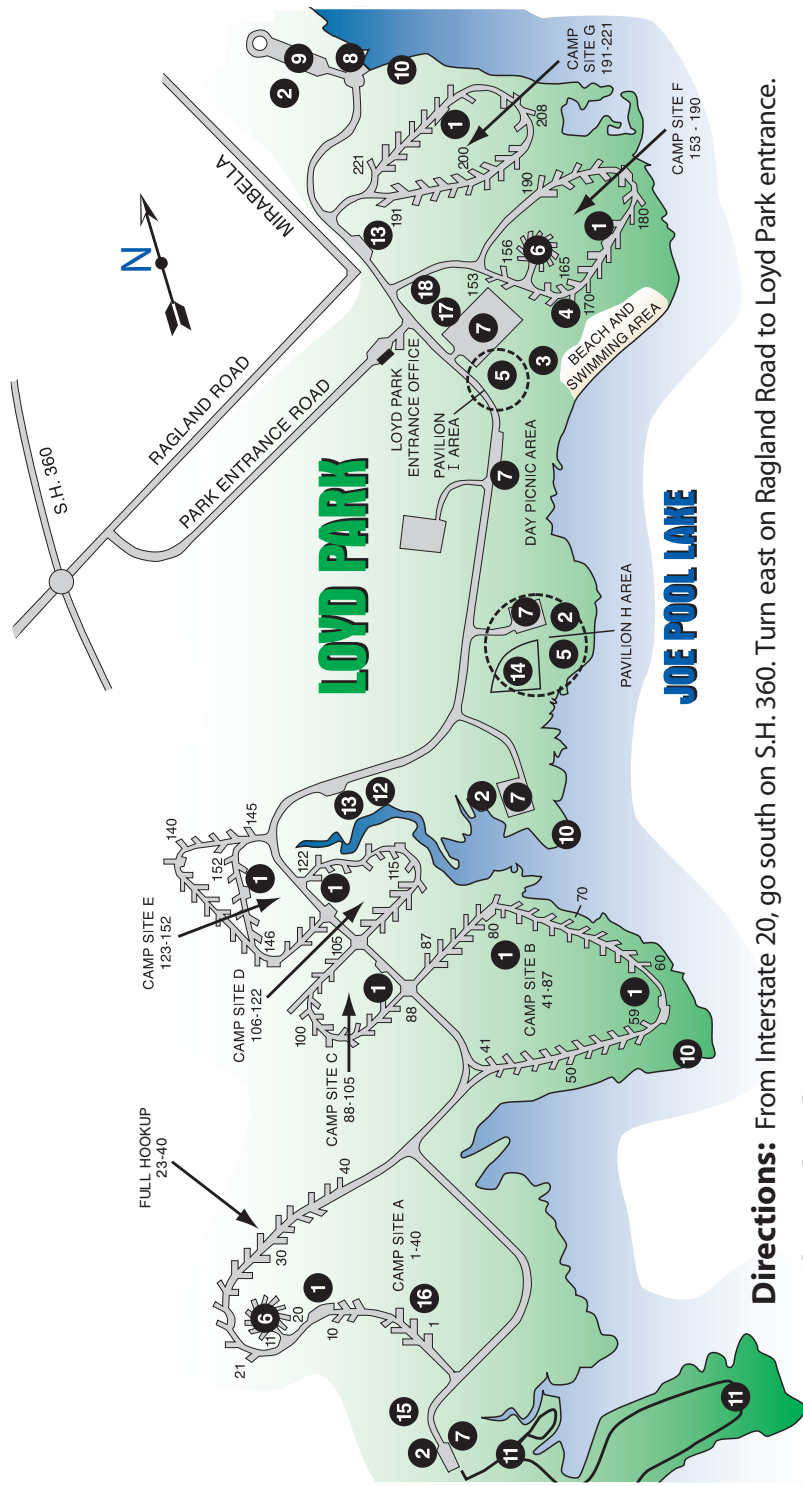

**Directions:** From Interstate 20, go south on S.H. 360. Turn east on Ragland Road to Loyd Park entrance.

**Legend - Loyd Park:**

- 1. Showers
- 2. Restroom
- 3. Beach Changing House
- 4. Cabins
- 5. Group Picnic Shelter
- 6. Group Camping Area
- 7. Parking
- 8. Boat Ramp
- 9. Boat Trailer Parking
- 10. Boat Dock
- 11. Hiking Trail
- 12. Foot Bridge
- 13. Sanitary Dump Station
- 14. Softball Field
- 15. Equestrian Trail Parking
- 16. Equestrian Camping
- 17. Camp Store
- 18. Loyd Lodge